

PART NAMES AND LOCATIONS

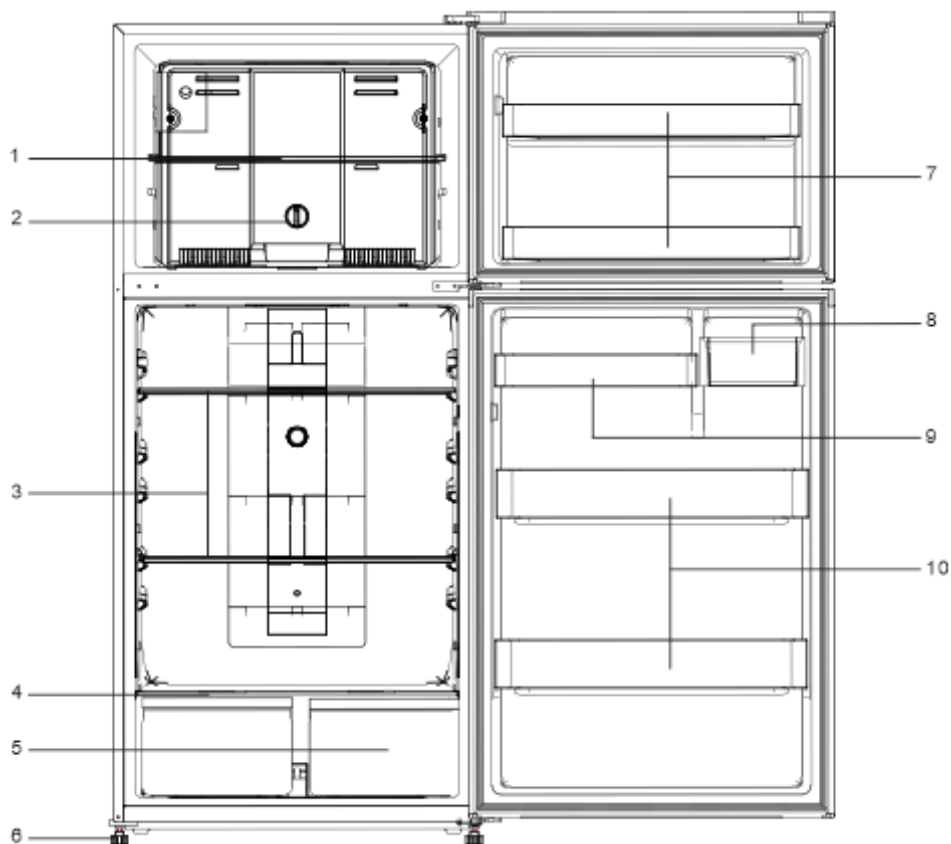

No	Description
1	Freezer Glass Shelf
2	Air Control Knob
3	Fridge Glass Shelf
4	Crisper Cover
5	Crisper
6	Adjustable Feet
7	Bottle Shelves
8	Butter Box
9	Little Fridge Door Shelf
10	Bottom Bottle Shelf

IN ACCESSORY BAG: USER MANUAL, WARRANTY, Door reversal parts(upper hinge and hinge cover)

As the manufacturer holds the authority to redesign or modify its products without notice:

Any modifications or upgrades of our products will result in this refrigerator varying slightly from this manual but the functionality will remain the same to that as set out within this manual.

IMPORTANT SAFETY INSTRUCTIONS



Follow these basic precautions to reduce the risk of fire, electrical shock hazards or injury when operating the refrigerator:

- **This product has been designed for using in a normal domestic environment. It is not intended for commercial use which will avoid warranty, such as supermarket, food shop, pharmacy, commercial kitchen & etc.**
- Persons with lack of experience and knowledge, reduced physical or mental capabilities, need to be given supervision or instruction concerning use of the appliance by a person responsible for their safety.
- Children should be supervised to ensure that they do not play with the appliance. Cleaning and user maintenance shall not be made by children without supervision.
- It is critical use this appliance safely. Read all instructions before operating the refrigerator and do not attempt to repair or modify this unit in any way as it can cause harm or void the warranty.
- Please ensure all persons using this appliance are also informed and comply with the details set out within this manual and the product Terms and Conditions.
- When unpacking the appliance for the first time, keep all cardboard and plastic packaging out of reach from children.
- Report any notable defects with the appliance to Chiq or retailer as soon as it is noted. Failure to do so can result in a non-warranty claim. Keep all packaging materials in a safe location until the unit has been installed properly.
- If the supplied power cord of this unit is damaged, it must be replaced by qualify service agent or similarly qualified persons in order to avoid any risk of injury. It is recommended the power cord is situated in a safe location when operating or transporting the appliance to prevent any damage that may cause electrical shock or fire hazards.
- **DANGER or WARNING:**

This unit is not designed for outdoor installation.

Service of this unit

The installation or any service of the appliance is recommended by a qualified technician or service company.

Ventilation Hazards

Never clean the refrigerator or refrigerator parts with flammable fluids, or store gasoline or any other flammable vapors and liquids in the vicinity of this or any other refrigerator as the gas and/or vapour can cause a fire hazard, explosion or inhalation.

Electrical Connection

Make certain, when installing or moving the unit that the power outlet has been connected to, has been fitted by a qualified electrician and the ground wire has been connected properly to meet the Australian Electrical Standards.

R600a WARNINGS

NOTE: This model uses R600a flammable refrigerant in its sealed system.

The following must be observed for your safety:

R600a Refrigerant Warning

- This appliance contains **0.052kg** R600a refrigerant which is environmentally friendly, but flammable. It does not damage the ozone layer, nor does it increase the greenhouse effect.
 - During transportation and installation, ensure that the tubing of the refrigerant circuit is not damaged.
 - Leaking refrigerant can ignite and may damage the eyes.
 - In the event any damage does occur, avoid exposure to open fires and any device which creates a spark. Disconnect the appliance from the mains power.
 - Thoroughly ventilate the room in which the appliance is located for several minutes.
 - Notify Customer Service for necessary action and advice.
 - The room for installing the appliance must be at least 1 cubic metre per 8 grams of refrigerant. The refrigerant quantity contained in this appliance is listed above in grams; it is also noted on the Rating Plate of the appliance.
- * Do not store explosive substances such as aerosol cans with a flammable propellant in this appliance.

It is hazardous for anyone other than an Authorised Service Person to carry out servicing or repairs to this appliance. In Queensland the authorized

person must hold a Gas Work Authorisation for hydrocarbon refrigerants, before carrying out servicing or repairs which involve the removal of covers.

1. Keep ventilation openings, in the appliance enclosure or in the built-in structure, clear of obstruction.
2. Do not use mechanical devices or other means to accelerate the defrosting process, other than those recommended by the manufacturer.
3. Do not damage the refrigerant circuit.
4. Do not use electrical appliances inside the food storage compartments of the appliance, unless they are of the type recommended by the manufacturer.
5. Do not store explosive substances such as aerosol cans with a flammable propellant in the appliance.



Warning: Risk of fire/flammable materials

6. WARNING: When positioning the appliance, ensure the supply cord is not trapped or damaged.
7. WARNING: Do not locate multiple portable socket-outlets or portable power supplies at the rear of the appliance.

Disposal

The environment and personal safety must be considered when disposing of this appliance. Please ensure the appliance is taken to a recycle center for safe recycling. DO NOT dispose of the appliance in land fill as the insulation and refrigerant gas contained in these appliances are flammable.

DOOR REVERSAL INSTRUCTIONS

Door reversal job requests some spare parts which are in the accessory bag, top hinge and hinge cover.

The following tool is required, flat screwdriver, phillips screwdriver, adjustable spanner, socket wrench and 8mm socket.

1. Make sure that your refrigerator is unplugged.
2. Remove one screw in the hinge cover, remove hinge cover and three screws, then remove the upper hinge.



3. Remove the freezer compartment door from the cabinet.

4. Remove the two screws that secure the center hinge.

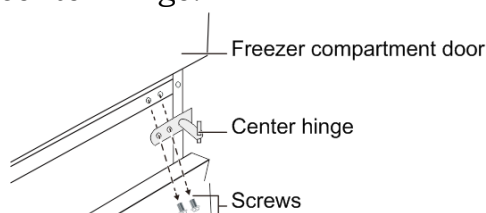

5. Remove the refrigerator compartment door.

6. Remove the four screws that secure the lower hinge to the right side of the cabinet, then remove the hinge.

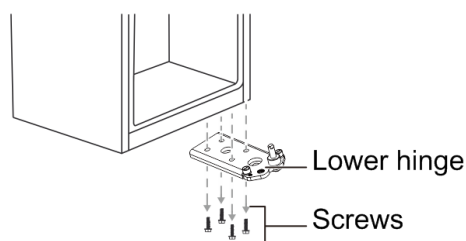

7. Remove the washer and nut that secure the pin shaft to the right hole on the lower hinge, then remove the shaft and pin screw

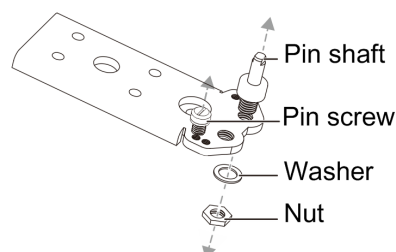

8. Insert the pin screw into the right hole and insert the pin shaft into the left hole on the lower hinge,, then secure the shaft with the washer and nut.

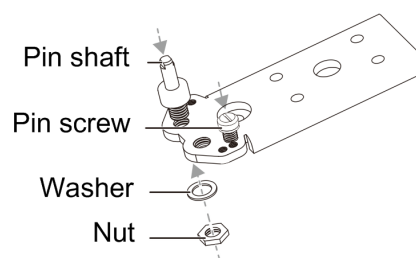

9. Install the lower hinge on the left side of the cabinet.

10. Remove the screw that secures the door stops from the bottom right of the refrigerator compartment door, then remove the door stops and install to the bottom left side.

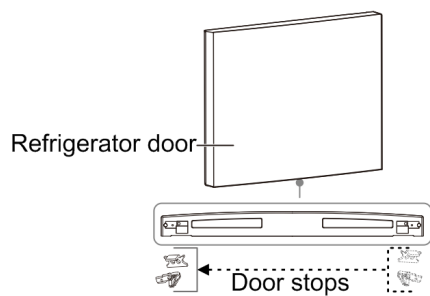

11. Install the refrigerator compartment door.

12. Move the door bushing from the top right side of the refrigerator door to the top left side of the door. And move the left hole cover to the right side.

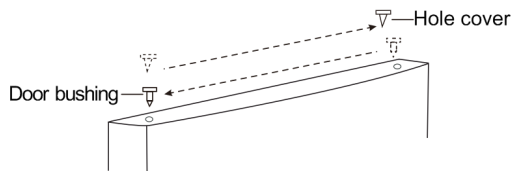

13. Remove screws and the center hinge screw hole plug on the left side of the cabinet, then install in the screw holes on the right side of the cabinet.

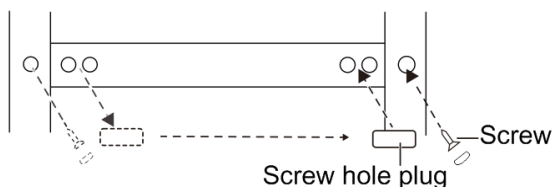

14. Install the center hinge to the left side with the two screws you removed previously.

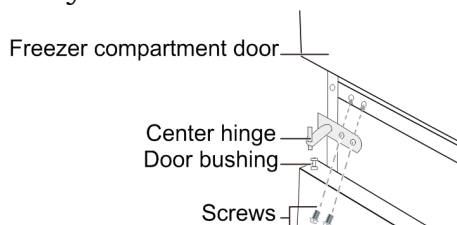

15. Remove the screw that secures the door stops from the bottom right of the freezer compartment door, then remove the door stops and install to the bottom left side.

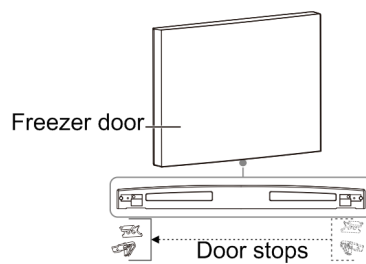

16. Install the freezer compartment door.

17. Move the door bushing from the top right side of the freezer door to the top left side of the door. And move the left hole cover to the right side.

18. Remove the screw that secures the hinge screw hole cover from the top left side of the cabinet, remove the cover and secures the cover on the top right side of the cabinet.

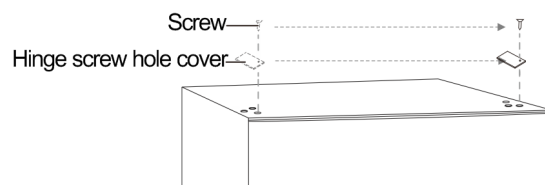

19. Secure the upper hinge to the top left side of the cabinet with the three screws you removed previously. Before you tighten the upper hinge screws, make sure that the top of the door is level with the cabinet and that the rubber gasket makes a good seal.

20. Install the hinge cover over the hinge on the top left side of the cabinet.

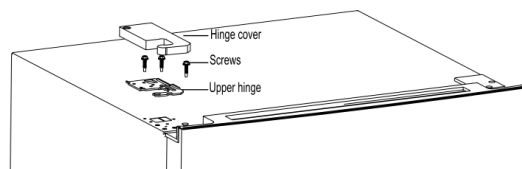

INSTALLATION INSTRUCTIONS

Before Using the Refrigerator

- Remove the exterior and interior packing.
- Before connecting the refrigerator to a power source, let the unit stand upright for approximately 4 hours to mitigate the possibility of a malfunction in the cooling system from improper handling during transportation.
- Clean the interior surface with warm water using a soft cloth.

Installing the Refrigerator

- This appliance is designed to be free standing only, and should not be recessed or built-in.

W	D	H	A	B	C(°)	E	F
750	785	1680	1280	1490	130±5	50	100

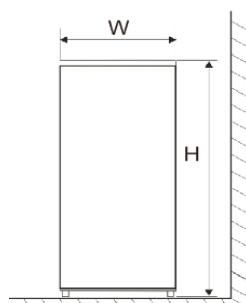

Fig. 1

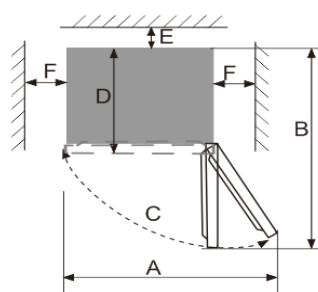

Fig. 2

- **Allow at least 5cm of space between the back and sides of the refrigerator to allow proper air ventilation.** Insufficient space will result in cooling and working life issue and voiding warranty.
- Place the refrigerator on a **leveled/even** floor surface that is strong enough to support the weight of the refrigerator when it is fully loaded to prevent vibrations.
- **Place the refrigerator on a concrete, tile floor or waterproof floor is recommended. The fridge will produce defrost water or condensation moisture, it might cause water damage in some extreme circumstances.**
- **The front feet can be adjusted to level the appliance properly.** Adjust the two front feet to keep the refrigerator leveled or elevated.
- Situate the refrigerator away from direct sunlight and sources of direct heat (stove, heater, radiator, etc.). Direct sunlight may also affect the acrylic coating and heat sources may cause an increase power consumption.
- This unit is not designed for outside installation.
- Avoid situating the refrigerator in moist OR **pest infestation** areas.
- Plug the refrigerator into dedicated, properly installed-grounded wall outlet. Do not under any circumstances cut or remove the third (ground) prong from the power cord. Any questions concerning power and/or grounding should be directed toward a certified electrician or an authorized service center.
- After plugging the appliance into a wall outlet, turn the unit on and allow the unit to cool down for 4-6 hours before placing food in the refrigerator.
- Do not place heavy items on the top of this appliance.

ENERGY SAVING TIPS

- Allow hot foods to cool to room temperature before placing in the refrigerator. Overloading the refrigerator forces the compressor to work harder. Foods that freeze too slowly may lose quality, or spoil.
- Be sure to wrap foods properly, and wipe containers dry before placing them in the refrigerator. This cuts down on frost build-up inside the refrigerator.
- Organize and label food to reduce door openings and extended searches. Remove as many items as needed at one time, and close the door as soon as possible.

OPERATING INSTRUCTIONS

START

The temperature inside the refrigerator is controlled by the potentiometer installed in the refrigerator. The temperature inside the refrigerator varies depending on the opening and closing doors of the refrigerator, the ambient temperature.

Functions

Temperature setting

Press the Temp button to adjust the temperature. After the temperature is adjusted to the expected gear, the setting will take effect if no more key operation is performed within 5 seconds, and the corresponding gear will be operated immediately. Temperature gear setting cycle sequence: "5-4-2-8-6-5"

Fast cooling

As the fridge chamber cools quickly, so does the temperature of the freezer to ensure that the food is well preserved with nutrition and good taste. Quick cooling function can be maintained for up to 30 hours. After that, it will automatically exit and the temperature gear will return to the setting before the quick-cooling feature was enabled.

Enter the fast-cooling function

Press the Mode button till the fast-cooling icon blinks. Within 5 seconds, if no more key operation is performed, the fast-cooling icon remains steady on to complete the setting.

Exit the fast-cooling function

After 30 hours of operation, the fast-cooling function will automatically exit.

Under the fast-cooling function, press the Mode button until the Intelligence icon flashes. Within 5 seconds, if no more key operation is performed, it will enter the intelligence function and exit the fast-cooling function.

Under the fast-cooling function, press the Temp key to adjust the temperature to the expected gear. Within 5 seconds, if no more key operation is performed, it will enter the corresponding temperature gear control operation and exit the fast-cooling function;

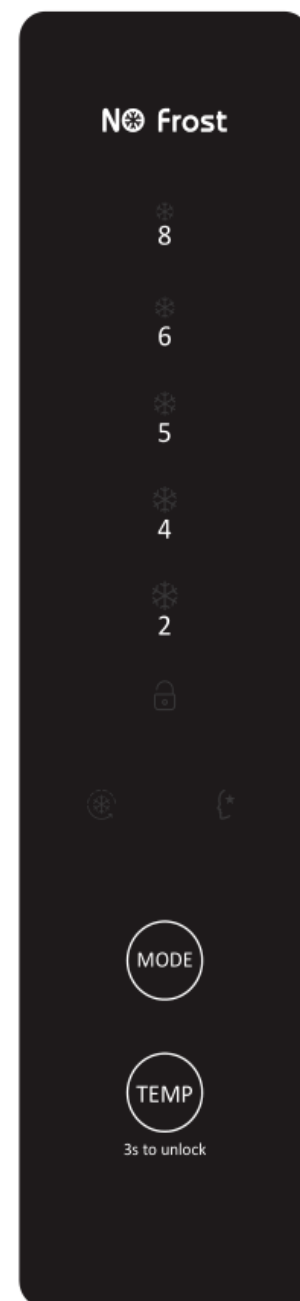

Intelligence

The fridge chamber enters the intelligent mode, and the products will adjust the temperature in the chamber automatically according to the real-time monitoring of the temperature in the fridge and the ambient temperature, so as to ensure the fresh and long-term storage of the ingredients in the fridge.

Enter the intelligence function

Press the Mode button until the intelligence icon blinks. Within 5 seconds, if no more button operation is performed, the intelligence icon remains steady on to complete the setting.

Exit the intelligence function

Under the intelligence function, press the Mode button till the icon of fast cooling flashes. Within 5 seconds, if no more key operation is performed, it will enter the fast-cooling function and exit the intelligence function;

Under the intelligence function, press the Temp key to adjust the temperature to the expected gear. Within 5 seconds, if no more key operation is performed, it will enter the corresponding temperature gear control operation, and exit the intelligent function.

Child Lock

When the Child Lock function is enabled, the temperature and function are subjected to no change to prevent maloperation.

In case of no key operation within 3 minutes, the Child Lock function will be enabled automatically.

Exiting the Child Lock function manually

Press and hold down the TEMP (3s to Unlock) for 3s, then the Child Lock function can be disabled.

Door open alarm

If the refrigerator door is open for more than 3 minutes, buzzer alarms will be continuously issued, which can be stopped when any key is pressed, but will be restored after 3 minutes if the door keeps open. The alarms will not be lifted until the refrigerator door is closed.

Power cut memory

In the case of power failure, the refrigerator will maintain the running state that is set before the power outage when the power supply is restored.



Power-on delay

In order to protect the refrigerator compressor from being damaged in the case of short-time power failure (i.e., less than 5 minutes), the compressor will not be started immediately after it is powered on.

Fault alarm

When the indicator light of temperature mode 2, temperature mode 5 or temperature mode 8 keeps flashing, the refrigerator is faulty, please contact the after-sales staff for home service as soon as possible.

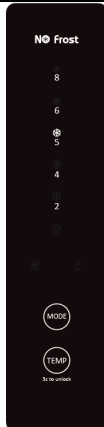
Temperature settings are recommended as following, but settings need to be adjusted according to the working environment.

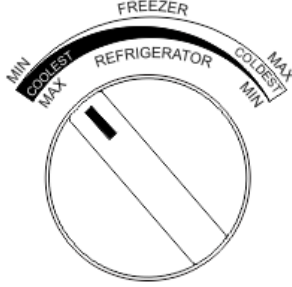
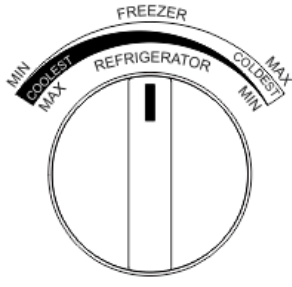
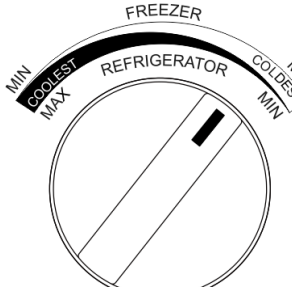
Temperature adjustment	Use environment	Higher than 35°C	16°C-35°C	Lower than 16°C)
	Recommended mode setting on the display panel			
	Recommended air control knob position			
Notes		1) It is recommended to set at the middle mode. 2) The temperature modes can be adjusted as recommended in the left table in case of change to the ambient temperature around the refrigerator.		

Please note different sections of refrigerator compartment may be warmer or cooler than others – typically the back wall and bottom lowest shelf will be the coolest, the top door rack will be the warmest. To avoid frost bite, please don't put raw vegetables too close to the coolest area.

GENERAL CARE AND MAINTENANCE

Cleaning the Refrigerator

- Upon installation of your new appliance, it is recommended that it be cleaned thoroughly and properly maintained thereafter.
- Turn off the refrigerator and then unplug the unit from the wall outlet.
- Remove all food content before washing the inside with a damp cloth soaked in lukewarm water and dishwasher liquid. **Don't use any chemical detergent which might damage the fridge.**
- Be sure to keep the door gasket (seal) clean to keep the unit running efficiently as improper cleaning can cause the seal to dislodge and tear.
- Dry the interior and exterior with a soft cloth.

Vacation Time

- Turn off the refrigerator first and then unplug the unit from the power point.
- Remove all food.
- Clean the refrigerator.
- Leave the lid open slightly to avoid possible formation of condensation, mold, or odors.
- Use extreme caution in the case of children. The unit should not be accessible to child's play.
- **Short vacations:** Leave the refrigerator operating during vacations of less than three weeks.
- **Long vacations:** If the appliance will not be used for several months, remove all food and unplug the power cord. Clean and dry the interior thoroughly. To prevent odour and mold growth, leave the door open slightly: blocking it open if necessary.

Repositioning and Relocating the Refrigerator

- Unplug the power cord from the wall outlet.
- Remove all the food and drinks.
- Securely tape down all loose items inside your refrigerator.
- Tape the doors to be closed securely.
- It is recommended that the refrigerator stays in the upright position during transportation. But if it is laid down for transport purpose, please lift it up immediately after the job is done. Please wait for at least 24 hours before putting the power.

TROUBLESHOOTING GUIDE

Problem	Solution
The fridge has no power	<ul style="list-style-type: none"> ➤ Power cord isn't plugged in properly. ➤ The circuit breaker tripped or a blown fuse. ➤ Try a different power point.
The light is not working.	<ul style="list-style-type: none"> ➤ There is no light in freezer compartment, only fridge compartment has light. ➤ Make sure the power is connected to the unit.
Compressor runs all the time	<ul style="list-style-type: none"> ➤ The room temperature is hotter than normal. ➤ A large amount of food has been added to the refrigerator. ➤ The door is opened too often. ➤ The door is not closed completely. ➤ The temperature control is not set correctly. ➤ The door gasket does not seal properly. ➤ The refrigerator does not have the correct clearances. ➤ The refrigerator has recently been disconnected for a period of time. 6+ hours are required for the refrigerator to cool down completely pending on operating conditions.
Freezer is too cold and refrigerator is too warm	<ul style="list-style-type: none"> ➤ Change freezer air flow setting to min position ➤ The fridge might need a manual defrost due to too much moisture went into the freezer part and blocked the air channel. To do so, Keep food in a container with ice bag or another fridge if it is available. Keep both doors opening and unplug the power cord for 24 hours. Then turn on the unit and it will work properly again.
Temperature inside the refrigerator is too warm.	<ul style="list-style-type: none"> ➤ Temperature control is set incorrectly. Turn the control to a cooler setting and allow several hours for the temperature to stabilize. ➤ Change freezer air flow setting to min position. ➤ Door is kept open too long or is opened too frequently. Warm air enters the refrigerator every time the door is opened). Open the door less often. ➤ The door is not closed completely. ➤ The door gasket does not seal properly.

Temperature inside the refrigerator is too cold.	<ul style="list-style-type: none"> ➤ Freezer control incorrectly set. Set back to mid position. ➤ Temperature control is set too cold. Turn the control to a warmer setting and allow several hours for the temperature to stabilize.
Temperature of external refrigerator side walls are warm.	<ul style="list-style-type: none"> ➤ The exterior refrigerator walls can be as much as 15-20 degrees warmer than room temperature. This is normal while the compressor works to transfer heat from inside the refrigerator cabinet to the condenser behind the refrigerator side walls.
Popping or cracking sound when compressor comes on.	<ul style="list-style-type: none"> ➤ Metal parts undergo expansion and contraction, as in hot water pipes. This is normal. Sound will level off or disappear as refrigerator continues to run.
Bubbling or gurgling sound, like water boiling.	<ul style="list-style-type: none"> ➤ Refrigerant (used to cool refrigerator) is circulating throughout the system. This is normal operation.
Vibrations.	<ul style="list-style-type: none"> ➤ Check the refrigerator is on a level/even surface. ➤ Refrigerator rocks on the floor when it is moved slightly. Be sure floor can adequately support refrigerator. ➤ Level the refrigerator by putting wood or metal shims under part of the refrigerator. ➤ The refrigerator is touching the wall. Re-level the refrigerator and move it from the wall. See "Installation Instructions".
Moisture forms on inside refrigerator walls.	<ul style="list-style-type: none"> ➤ Weather is hot and humid, which increases internal rate of frost build-up. This is normal. ➤ Door is slightly open. ➤ Door is kept open too long, or is opened too frequently. Open the door less often. ➤ The door is not sealed properly.
Moisture forms on outside of refrigerator.	<ul style="list-style-type: none"> ➤ Door is slightly open, causing cold air from inside the refrigerator to meet warm moist air from the outside.
The doors will not close properly.	<ul style="list-style-type: none"> ➤ The refrigerator is not on a level surface. ➤ The gasket/s may be dirty or not properly maintained. Clean the seals and make sure they are dry before closing the door/s. ➤ The storage basket and/or shelves are out of position.

For any enquiries, please call the CHiQ Customer care on: 1300 796 688