

vapour^{M1}

MULTI FLOOR ULTRA DRY STEAM

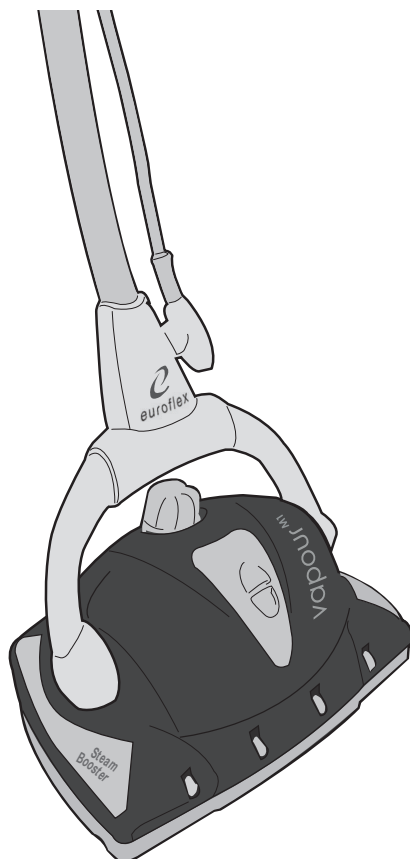

Floor Steam Cleaner with Frontal Steam Jet

INSTRUCTION MANUAL

Before using this product, please read the instructions and keep it for future references

CUSTOMER SERVICE:
1800 663 866 (AUS) 0800 666 783 (NZ)

Model #: EZ1-R AUS, NZ

IMPORTANT SAFE T

SAVE THESE INSTRUCTIONS

SAFETY WARNING

- The manufacturer reserves the right to make changes to the design and features of the appliance without notice.
- This appliance is solely for household use.
- Do not turn the appliance on if the Steamer shows signs of damage, the power cable is damaged or if the appliance has been potentially subject to non-identifiable damage (e.g. the appliance as been dropped, etc.).
- Do not plug in the appliance until you are sure the electrical voltage supply corresponds to the required voltage shown on the machine plate.
- The electric socket should be earthed and equipped with a 10A automatic circuit breaker.
- Any extension cables should be checked to ensure they are rated 10A and suitable for the appliance. Cables should be completely unwound prior to use.
- The appliance should not be used if there are visible signs of damage or leakage.
- The manufacturer declines any responsibility for damage to persons or equipment, in the event that the equipment is damaged as a result of improper use, unauthorized repair or unauthorized maintenance work.
- Repairs should be carried out solely by personnel authorized by the manufacturer. Equipment repaired by personnel who are not authorized to do so, represent a risk and, as such, are not covered by the warranty.
- The power cable should only be replaced by technical support personnel who have been authorized by the manufacturer.
- Do not use the appliance outdoors.
- Do not expose the appliance to external atmospheric agents, dampness or heat.
- Use a dry or slightly damp cloth to clean the appliance.
- Use solely manufacturer-recommended accessories or spare parts.
- The steam released from the appliance is extremely hot. Both appliance and accessory tools may scald. Avoid direct contact. The steam symbol  (symbol 5597 relative to IEC 60417-1) warns operators that there is the risk of scalding!
- This appliance is not suitable for children, the physically or mentally disabled, or persons without the necessary experience and know-how to handle the machine, unless they have been adequately trained by safety personnel.
- Keep out of the reach of children.
- Keep the appliance in a safe dry place out of the reach of children when not in use.
- Do not pull on the cable. Do not use the cable to move the appliance. Do not exert undue pressure on the cable (i.e. when closing a door). Avoid any contact with sharp edges and corners. Keep the cable away from hot surfaces.
- No parts connected to an electrical power supply (switch, plug, electronic components, etc.) should be in contact with water.
- Disconnect the appliance from the power supply prior to any maintenance or cleaning operations. Allow the Steamer to cool down.
- Do not leave the equipment unguarded. Remove the power supply in the event the machine remains unattended for a period of time.
- Never use cleaning solutions, perfumes, oils or other chemical substances other than tap or distilled/demineralized water in the Steamer. Use of chemicals may damage appliance and will void your warranty.
- Do not overturn or lean the appliance unduly to one side.
- Do not point the jet of steam in the direction of people, animals, plants, electrical or household appliances.
- Do not insert any objects in the various openings and do not use the appliance if any opening is obstructed.
- Do not use the appliance with wet hands or bare feet.
- Do not use the appliance when close to flammable or explosive substances.

TY INSTRUCTIONS

Please contact your closest technical support centre should you require further information or instructions not contained in this document.

Customer Support Centre:

Australia: 1800 663 866

New Zealand: 0800 666 783

Dispose of plastic packaging appropriately, as it may represent a potential hazard for children!

IMPORTANT: Before operating the unit for the first time, read these instructions carefully and keep them for future reference.

Euroflex relieves itself of any liability for damages that shall be the result of improper use of the appliance, not in conformity with what's written in this instruction manual.

WARNING: This appliance must be earthed.

The appliance must be connected to a 220-240 volt 50/60Hz AC supply by means of a three pin socket, suitably earthed.

CAUTIONS

- **Do not use your Floor Steamer without a Hard Surface Pad or Carpet Glide & Pad attached to the system.**
- **Never leave your Floor Steamer in one spot on any surface for any period of time. Always place on the Parking Pad and make sure that the Floor Steamer Handle Assembly is in the full "UP POSITION" when not in use - this turns the Steamer Off.**

IMPORTANT

Please read all of the instructions for use and Important Safety Instructions carefully. Remove and discard all packaging materials and keep them out of the reach of children.

● Save your back

No need to press hard

The steamer does the work for you



Attention: the photographs and/or drawings in this document are for illustrative purposes only. Actual appliance and the accessories may vary due to product enhancement.

Safety Informations in Digital Format: www.plastecs.it/warning

SAVE THESE INSTRUCTIONS

One (1) Floor Steamer

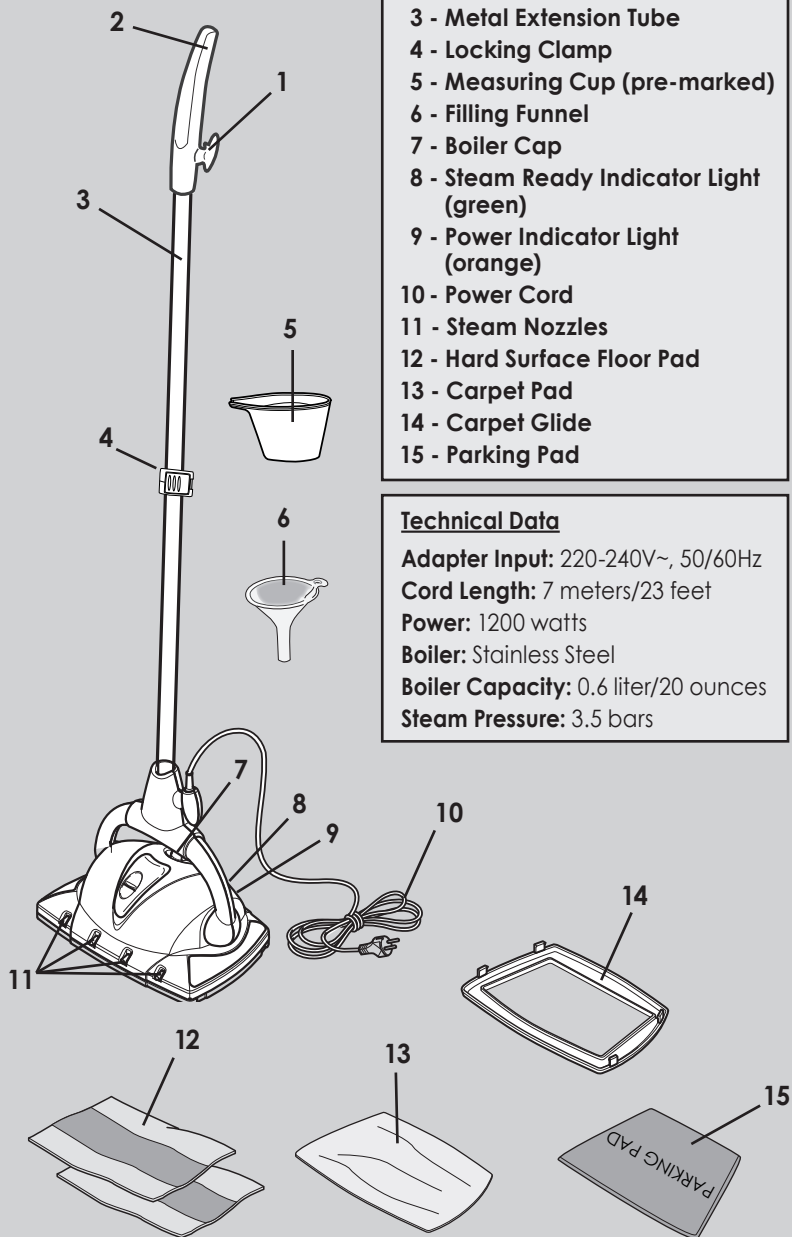

- 1 - Cord Winder
- 2 - Handle
- 3 - Metal Extension Tube
- 4 - Locking Clamp
- 5 - Measuring Cup (pre-marked)
- 6 - Filling Funnel
- 7 - Boiler Cap
- 8 - Steam Ready Indicator Light (green)
- 9 - Power Indicator Light (orange)
- 10 - Power Cord
- 11 - Steam Nozzles
- 12 - Hard Surface Floor Pad
- 13 - Carpet Pad
- 14 - Carpet Glide
- 15 - Parking Pad

Technical Data

Adapter Input: 220-240V~, 50/60Hz
Cord Length: 7 meters/23 feet
Power: 1200 watts
Boiler: Stainless Steel
Boiler Capacity: 0.6 liter/20 ounces
Steam Pressure: 3.5 bars

1 Assembly of Parts & Preparation of Steamer

Make sure all parts are in the box (see pg 4).

IMPORTANT: FOLLOW THESE INSTRUCTIONS CAREFULLY!

A. Assemble Handle

After removing Handle Assembly from carton:

1. Pull Extension Tube apart until you see the lock opening (hole) on the Tube.

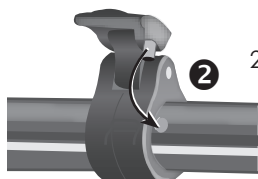
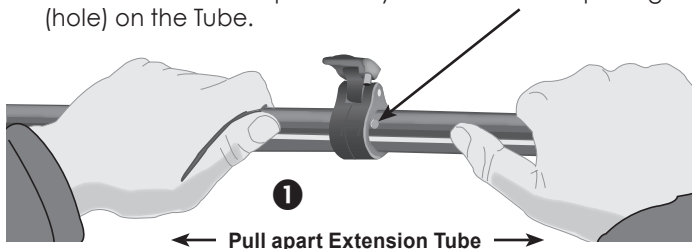

2. Line up the peg on Locking Clamp with the hole on Extension Tube and...

3. Snap the Locking Clamp closed, to lock the Extension Tube in position.

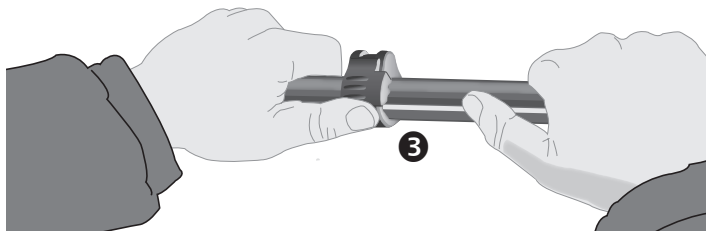

IMPORTANT

Frontal steam can only be generated when Extension Tube is in the "Maximum Extension" position. **BE SURE EXTENSION TUBE IS FULLY EXTENDED AND LOCKED IN PLACE FOR OPTIMAL STEAM OPERATION.**

B. Attach Handle to Steamer

- Before starting, remove the self-tapping screw from the bottom of Extension Tube.
- Insert the Handle Assembly into the Floor Steamer Base. Align Arrow on Handle with Arrow on Base (as shown in Fig. A).
- Once inserted, twist Handle Assembly 90° clockwise (as shown in Fig. B). Be sure Arrow on the Handle is aligned with Line/Lock Icon on Base.

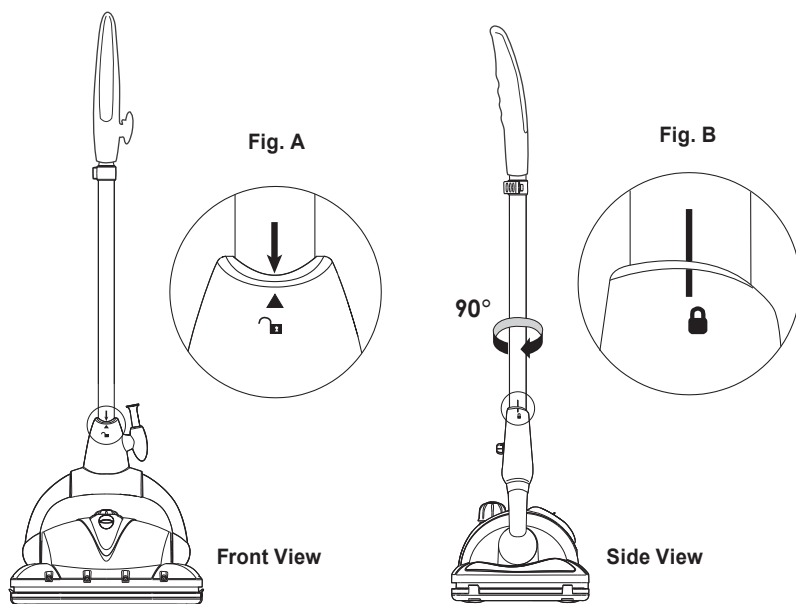
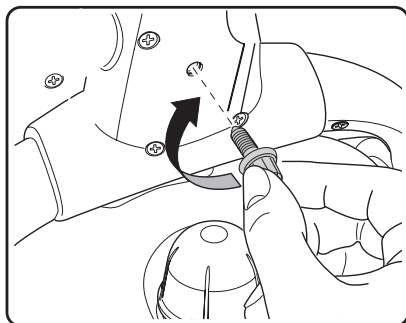

Fig. C



- Align the Handle Assembly screw hole with the opening in the steamer housing.

Secure the handle assembly with self-tapping screw which was removed from bottom of Extension Tube (as shown in Fig. C).

C. Attach Hard Surface Floor or Carpet Pad to Steamer

Affix either the Hard Surface Floor Pad or Carpet Glide with Carpet Pad to your Floor Steamer.

WARNING: To prevent floor damage, ALWAYS attach either the HARD SURFACE FLOOR PAD or the CARPET GLIDE ACCESSORY with CARPET PAD when using your Floor Steamer. NEVER use without either of these attachments affixed to the machine.

ATTACHING HARD SURFACE FLOOR PAD

Place Floor Pad face down on the floor, with white hook and loop strips facing up. Hold Floor Steamer about 2" above Pad and gently place Floor Steamer onto the Pad. Firmly press down to ensure Pad is securely adhered to the Floor Steamer.

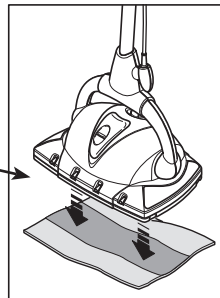

ATTACHING CARPET GLIDE WITH CARPET PAD

Place Carpet Glide face up on floor. Center and place Carpet Pad on top of Carpet Glide. Hold Floor Steamer over Carpet Glide and gently lower the Steamer onto the Glide. Make sure the 4 clips on Glide are around the outside of the Steamer Base and using hands, attach the 4 clips of the Carpet Glide to the Steamer Base.

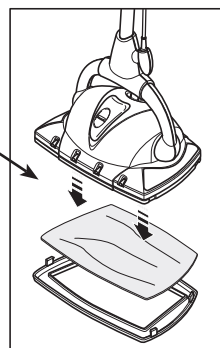

USE ON HARDWOOD FLOORS

For hardwood floors, use only on "sealed" hardwood surfaces. Move Steamer forward and backward while cleaning, carefully observing the amount of steam used, as too much water could cause damage.

IMPORTANT NOTE ABOUT LINOLEUM FLOORING

Steam can cause wax to be stripped from, and consequently damage, some varieties of linoleum flooring. ALWAYS test a small, inconspicuous portion of the floor BEFORE using steam to ensure that your linoleum floor does not have this issue. For some varieties of linoleum or vinyl floors the floor steamer is harder to push forward and back.

NOTE: See "Maintenance & Cleaning" (page 13) for care and cleaning instructions for Microfiber Pads.

D. Filling Boiler with Water

WARNINGS:

- Carefully read all instructions before removing Boiler Cap.
- Always unplug appliance before filling the Boiler.

IMPORTANT

Use ordinary tap water. Distilled or demineralized water is recommended if tap water is too hard. DO NOT add detergents, perfumes, oils, or other chemical substances to the Boiler. The product warranty will be null and void if anything other than water is added to the Boiler.

Follow these instructions to avoid overfilling the Boiler.

- Be sure appliance is unplugged from the electrical power outlet, and has **cooled for at least 5 minutes before filling with water.**
- **Make sure Handle Assembly is in the upright "off" position.** Remove Boiler Cap by turning it counterclockwise.

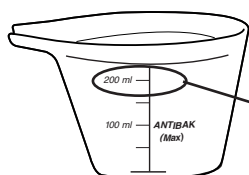
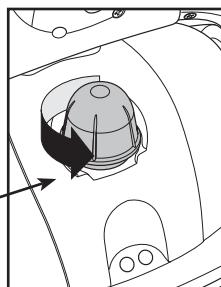

- Pour in 600 mls of water using the Measuring Cup and Filler Funnel provided – fill cup to the "200 ml" marking three times. **Be careful not to overfill the Boiler.** Please note that excess water will be flushed out during use if the Boiler is overfilled, resulting in wet floors.

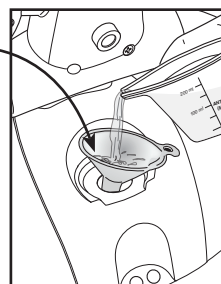

- Replace Boiler Cap by turning it clockwise. *Do not tighten Boiler Cap too much – finger tightening is sufficient to lock the steam in the Boiler.*

If using cold water, heating time is about 3-5 minutes. If using warm water, heating time is reduced.

IMPORTANT

- **Do not overfill the Boiler as excess water will be flushed out of the Boiler before dry steam will emit.**
- **If re-filling the Boiler while Steamer has been in use, be sure to allow Steamer to cool for at least 5 minutes and loosen Boiler Cap slowly to allow any excess steam to escape before completely removing Cap.** (See page 10, "Refilling Boiler During Use" for detailed instructions.)

2 Using Your Floor Steamer

A. Using the Parking Pad

You can use the Parking Pad if the Steamer is warm or hot.

CAUTION

The Parking Pad is provided to prevent floor damage that can result from leaving a hot steamer resting on the same spot for too long. ALWAYS place Floor Steamer on the Parking Pad when not in use, or while it is cooling before storage.

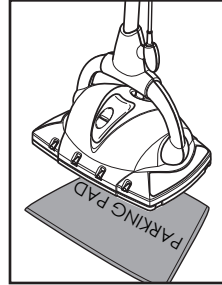

B. Starting the Appliance

- Be sure Boiler is filled with water and Boiler Cap is securely in place.
- Insert the plug into a 3-prong grounded electrical outlet (orange Power Indicator Light will illuminate).
- **Keeping the handle in the upright "Off" position**, wait until the (green) Steam Ready Indicator Light illuminates.

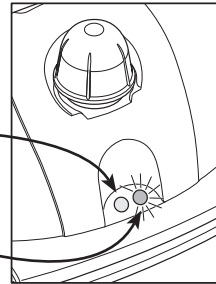

Once Boiler is filled and the green Steam Ready Indicator Light glows, Steamer is ready to clean.

PLEASE NOTE: The green Steam Ready Indicator Light will turn on and off during use. This is normal and not a fault.

C. Using Steam

- To emit steam from the underside of the Steamer, simply pull the Handle downwards.
- Return Handle to upright position to stop steam.

You will find that your Floor Steamer can easily clean most hard surfaces and floors using the steam from the underside alone.

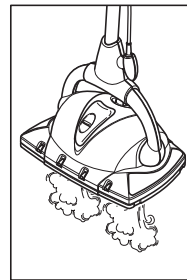
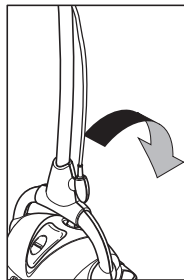

NOTE: Some water may be emitted when the handle is first pulled down after filling. This is normal.

Continued on next page

C. Using Steam (continued)

- To emit steam from the Steam Nozzles, pull the trigger on the Handle upward.

IMPORTANT

The Steam Nozzles are meant to be used in steam "bursts" and should never be used on a sustained basis. The Steam Nozzles will loosen especially difficult debris and will assist in cleaning hard to reach areas such as floor edges.

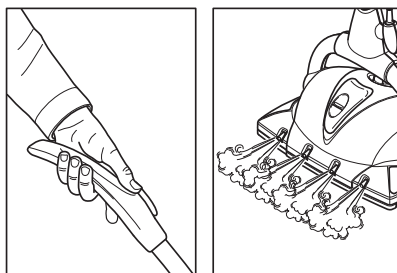

NOTE: Your Steamer will not need refilling for about 20-25 minutes of usage.

The Floor Steamer will stop producing steam when the Boiler is empty. When this happens unplug and store unit or refill with water per instructions (below).

NOTE: If the Floor or Carpet Pad becomes too wet or too dirty, replace with a clean, dry Pad and continue cleaning.

D. Refilling Boiler During Use

When the Floor Steamer has run out of water, there will be no more steam coming out of the unit. At this stage it is time to refill the Boiler. Follow the refilling instructions below.

IMPORTANT

The Floor Steamer has a Boiler that should not be overfilled. To avoid the potential for overfilling, only refill the Boiler when it is completely run out of water and only add 600ml. Always follow the practice of using the Floor Steamer until it has run out of water and then refill 600ml only.

If floor cleaning is completed and water remains in the Boiler, the Floor Steamer can be stored with the remaining water in the Boiler, there will be no harm done to the unit. At the next cleaning session simply heat up the unit and use the water already in the Boiler, then refill when empty.

Or alternatively at the next cleaning session, open the Boiler Cap when the unit is still cold and pour out the water and then refill (if this alternative method is used, it is recommended that only 500ml of water is added, because the unit will not completely drain when the water is poured out from the Boiler).

WARNING: Let Steamer cool 5 minutes before opening Boiler Cap. Use care when opening Boiler Cap as it may still be hot and steam may escape, causing burns. If Boiler is still hot, water may spurt out during refilling which can also cause burns.

- **Unplug the appliance from the electrical power outlet. This will stop the Steamer from continuing to heat up.**
- Once unplugged from the power outlet, place Handle in the "On" position to release any residual steam and pressure from the Boiler.
- After all steam and pressure has been expressed from the Steamer, return the Handle to the upright "Off" position.
- Slowly turn Boiler Cap counterclockwise. This will allow remaining steam to escape.
- **Be sure Steamer has cooled 5 minutes before refilling with water.**

The product warranty will be null and void if anything other than water is added to the Boiler.

- Pour in 600 mls of water using the Measuring Cup and Filler Funnel provided – fill the Measuring Cup to the 200 ml marking 3 times. *Be careful not to overfill the Boiler.*
- Replace Boiler Cap by turning it clockwise. *Do not tighten Boiler Cap too much – finger tightening is sufficient to lock the steam in the Boiler.*
- Insert plug into 3-prong electrical outlet. Wait for green Steam Ready Indicator Light to turn on. Steamer is ready to use once again.

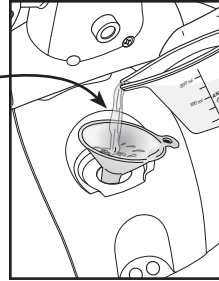

REMINDERS

- Always use ordinary tap water.
- If tap water is too hard, use distilled or demineralized water to avoid the risk of mineral deposits and sediment from forming.
- Do not add detergents, perfumes, oils or other chemical substances to the Boiler. This will damage the Steamer and void the warranty.
- The green Steam Ready Indicator Light may turn on and off during use. This is normal and not a fault.

IMPORTANT

Do not overfill the Boiler as excess water will be flushed out of the Boiler before dry steam will emit.

3 Cleaning the Floor Steamer

We recommend you periodically clean the Floor Steamer to prevent the accumulation of calcium, mineral deposits and other sediment caused by the use of tap water. After every 10-15 refills, fill the Boiler three-quarters full of hot tap water, shake several times and empty out the water into sink. Repeat several times to ensure that the Boiler is flushed of any calcium or mineral deposits. Wipe the Steamer base with a damp cloth and dry.

NEVER HOLD THE STEAMER UNDER THE TAP TO FILL. Use the Measuring Cup and Funnel provided to fill the Boiler.

If distilled or demineralized water is regularly used in the Steamer, cleaning of the Boiler can be done less frequently. In some areas tap water is very hard, it is recommended that the Boiler is cleaned more frequently if hard water is used.

The cleaning of the Boiler and Steamer is the sole responsibility of the appliance owner. Calcium, mineral deposits and other sediment left to build up in the Floor Steamer causing the Steamer to fail and/or the steam pathways in the Steamer to block, is not covered by the product warranty. Users must follow the cleaning instructions above.

If the Steamer and Boiler are not cleaned according to the instructions above and the product fails and/or the steam pathways are blocked, the appliance owner should send the product for servicing by contacting the Customer Support Line.

The Floor Steamer is intended for domestic household use only. It is not intended for commercial use. Any use other than for domestic household purposes will void the product warranty.

Microfiber Pad Care & Cleaning

Your Microfiber Pads are designed for hundreds of uses. Clean Pads regularly, either by hand (using mild soap and warm water) or in your clothes washer on a delicate cycle, cool water. Never use fabric softener or bleach. We recommend letting Pads air dry to maintain maximum long term effectiveness.

Replacement pads are available at most retail outlets.

Microfiber washing instructions – ULTRA MICROFIBRE

HARD SURFACE FLOOR PAD	CARPET PAD
90% Polyester / 10% Polyamide Hand wash only Tumble dry low or air dry No bleach / No fabric softener	90% Polyester / 10% Polyamide Hand wash only Tumble dry low or air dry No bleach / No fabric softener

Issues	Possible Causes	Solutions
Steam is not coming out of the Steam Nozzles.	Improper Handle assembly.	Call Customer Service to receive instructions to correct the problem.
The Hard Surface Floor Pad is not adhering to Steamer.	Not enough pressure was applied when attaching Pad.	Position Steamer about 2" above Pad and FIRMLY press it down onto the Pad.
	Floor Pad requires replacing due to age of the Floor Pad.	Replacement Floor Pads can be purchased at most electrical appliance retail outlets.
The Cleaning Pads are getting soaked (too wet). Why?	Boiler is overfilled.	Let Steamer run until excess water ceases. -OR- Remove some water from Boiler once the Boiler has cooled down completely.
	Green "Steam Ready Indicator Light" is not illuminated.	Wait for green "Steam Ready Indicator Light" to illuminate.
The steam seems to be making my floor too wet.	Front Steam Jets are being used too frequently.	Only use Front Steam Jets in short bursts for cleaning tougher dirt or to clean hard to reach areas.
	The Cleaning Pad is too wet (saturated with moisture)	Replace the wet Pad with a dry, clean Pad and continue cleaning.

IMPORTANT QUESTION:

Q: Do I always need to use a Microfiber Pad when cleaning with my Steamer?

A. YES! It is critically important to ALWAYS use your Microfiber Pads. The Floor Steamer should NEVER be used without either a Hard Surface Floor Pad or Carpet Glide with Carpet Pad.

This image shows a single sheet of white paper with horizontal ruling lines. The lines are evenly spaced and run across the width of the page. There are no margins, text, or other markings on the paper.

[illegible]

Customer Support

Customers needing assistance with their Floor Steamer can call the Customer Support Line on the phone numbers listed below. Customers should also call the Customer Support Line if they require product warranty repair or post-warranty product servicing. Our friendly Customer Service Team can assist you with getting the best cleaning results from your Floor Steamer, they are full of helpful steam cleaning tips, too.

Customer Support Line

AUSTRALIA 1800 663 866
NEW ZEALAND 0800 666 783

Euroflex Australia Pty Ltd

79 Furniss Road
DARCH WA 6065
AUSTRALIA
TEL: 08 9302 2526
Email: admin@euroflex.com.au
Website: www.euroflex.com.au

Euroflex New Zealand Ltd

c/- Dubins
137 Glenfield Road
Birkenhead Auckland 0626
NEW ZEALAND
TEL: 0800 666 783
Email: admin@euroflex.com.au
Website: www.euroflex.com.au

Plastecs SRL

Via dei Colli, 59
31058 Susegana (TV)
ITALY
Tel: +39 0438 453334
Email: info@plastecs.it
Website: www.euroflex-appliances.com

