

the Dicing Kit (8mm & 16mm)

Instruction Book - BFP005

Only use with BFP820 Food Processor or BFP006 Bowl & Lid



Breville



Contents

- 2 Breville recommends Safety First
- 5 Components
- 6 Assembly
- 7 Functions
- 9 Food Processing Guide - Dicing
- 10 Care & Cleaning

BREVILLE RECOMMENDS SAFETY FIRST

At Breville we are very safety conscious. We design and manufacture consumer products with the safety of you, our valued customer, foremost in mind. In addition we ask that you exercise a degree of care when using any electrical appliance and adhere to the following precautions.

IMPORTANT SAFEGUARDS

READ ALL INSTRUCTIONS BEFORE USE AND SAVE FOR FUTURE REFERENCE

- Carefully read all instructions before using the product for the first time and save for future reference.
- Handle the food processor and all attachments with care - remember the blades and grids are razor-sharp and should be kept out of reach of children.
- Remove and safely discard any packaging material and promotional labels before using the product for the first time.
- Care shall be taken when handling the sharp cutting blades and grids, emptying the bowl and during cleaning.

- Ensure the OFF button has been pressed, and the food processor is switched off and unplugged before attaching the Dicing Kit.
- Always operate the food processor with the processing lid securely in position.
- Do not push food into the feed chute with your fingers or other utensils. Always use the food pusher provided.
- Do not place the Food Processor on or near a hot gas or electric burner, or where it could touch a heated oven.
- Do not attempt to use the Dicing Kit by any other method than those described in this book.
- Cleaning and user maintenance shall not be made by children without supervision. Keep the appliance and its cord out of reach of children.

This appliance shall not be used by children. Always disconnect the appliance from the power supply if it is left unattended and before assembling, disassembly or cleaning. Be careful if hot liquid is poured into the food processor as it can be ejected out of the appliance due to a sudden steaming.

- This product is not intended for use by young children or infirm persons without supervision. Children should be supervised to ensure that they do not play with the appliance.
- This product is for household use only. Do not use this product for anything other than its intended use. Do not use in moving vehicles or boats. Do not use outdoors.

Misuse may cause injury.

- This product is for use with specific Breville food processors only. Do not attempt to use this Dicing Kit with any other food processors other than those models specified on the packaging.

FOR HOUSEHOLD USE ONLY
SAVE THESE INSTRUCTIONS



Components

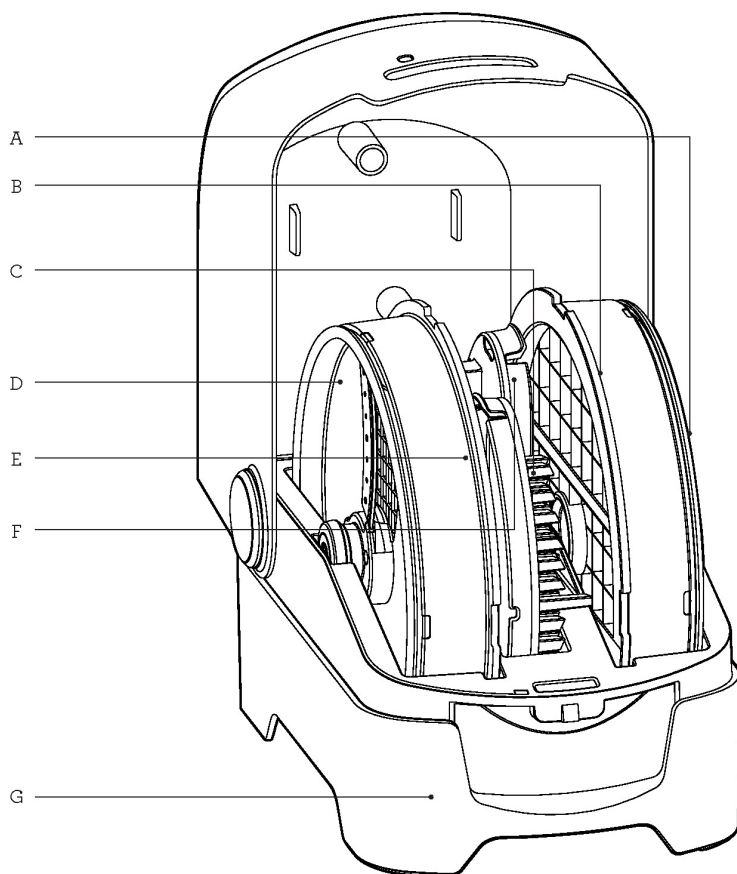

- A. 16mm Dicing Disc
For dicing 16mm cubes.
- B. 16mm Dicing Grid
For dicing 16mm cubes.
- C. 16mm Cleaning Cap
To clean the 16mm Dicing Grid.
Attaches to the Large Food Pusher.
- D. 8mm Dicing Disc
For dicing 8mm cubes.
- E. 8mm Dicing Grid
For dicing 8mm cubes.
- F. 8mm Cleaning Cap
To clean the 8mm Dicing Grid.
Attaches to the Large Food Pusher.
- G. Storage Box
For storing all Dicing accessories.



Assembly

- Position the Processing Bowl onto the Motor Base and turn the bowl clockwise until the handle locks to the front.
- Before placing the lid onto the Processing Bowl, place your Geared Spindle and position it over the coupling in the centre of the Processing Bowl.
- If you intend to dice larger quantities (more than 5 cups) please insert the Dicing Distributor after placing your geared spindle into the bowl. The Dicing Distributor will help to distribute diced food evenly across the bowl.



WARNING

Do not touch the blades of the Dicing Grid. They are extremely sharp.



- Place the Dicing Grid, ensuring to align with the 4 tabs in the bowl, then insert the Dicing Disc.
- Make sure you follow the right order and to match your Dicing Disc with your Dicing Grid. Each Dicing Grid creates cubes in different sizes and has its corresponding Dicing Disc in matching size.
- Do not use your Dicing Kit with the Disc Spindle. Always use the Geared Spindle.



NOTE

Only use the Dicing Kit with BFP820 Food Processor or BFP006 Bowl&Lid.

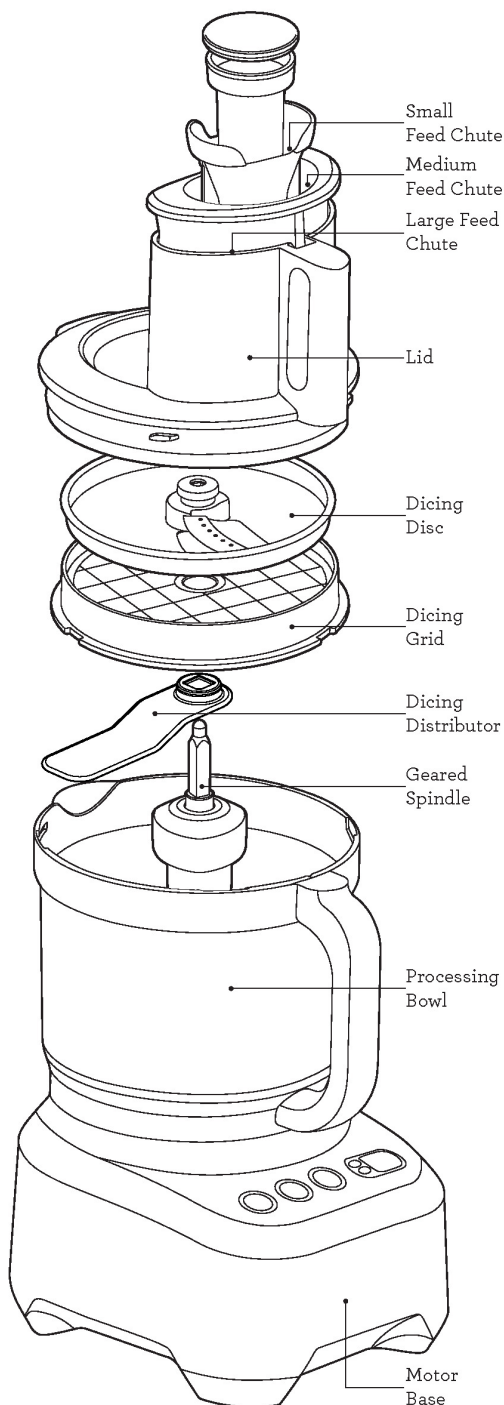



Functions

The Dicing Kits dice raw and cooked food into cubes of the size of 16mm x 16mm and 8mm x 8mm.

The small 8mm Dicing Kit is great for preparing for chunky Salsas and Guacamole, onions and other vegetables for soups. The 16mm Dicing Kit will cut bigger cubes which are ideal for salads.

Always remember to place the Geared Spindle, Dicing Grid and Dicing Disc into the food processor before adding the food. If you intend to dice larger quantities (more than 5 cups) please insert the Dicing Distributor after placing your geared spindle into the bowl. Do not dice more than 10 cups (2.4L) in your food processor at a time. If you need to dice more than this volume, always empty your bowl and then continue dicing. Exceeding this volume will lead to the product jamming in the disc and will make the cleaning process of the dicing grid challenging.

Use the START/PAUSE button for control when dicing food.

All three Dicing Grids (8mm, 12mm and 16mm) have their matching Cleaning Cap Tools (8mm, 12mm, 16mm).

To clear out remaining food from the Dicing Grid use the Dicing Cleaning Cap in the matching size of Dicing Grid after Dicing 10 cups or EACH USE. Immediately after dicing, remove the Dicing Disc from the bowl while leaving the Dicing Grid inside the bowl.

- Choose the right Cleaning Cap size and attach the Cleaning Cap to the bottom of the Large Pusher.
- Align the markings on the Cleaning Cap with the markings on the Dicing Grid, push down to clear out the food in the grid.
- Repeat four times going around the grid until the entire grid is cleared.

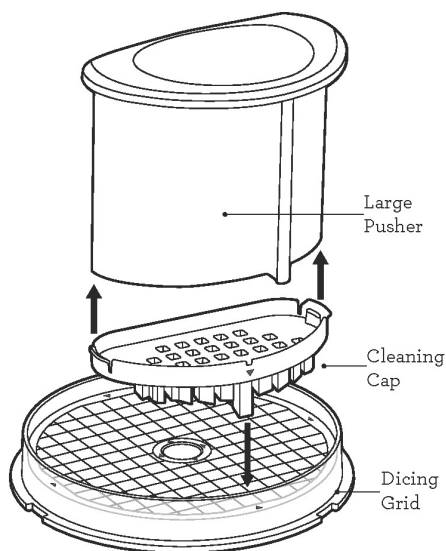

VEGETABLES AND FRUITS

The Dicing Kits can process raw and cooked vegetables and also fruits. To improve dicing results for harder vegetables like carrots and pumpkin, par-cooking is recommended.

DO NOT DICE SWEET POTATO (Yam/Kumara)

Due to its dry, fibrous texture dicing sweet potato is not recommended with the Dicing Kit.

Sweet potato places high load on the Dicing Kit which causes high friction and potential damage to the Bowl Lid.

CHOOSE THE RIGHT FEED CHUTE SIZE

For best results when dicing with raw, hard vegetables feed carrots length-ways through the Small Feed Chute, and feed pumpkin through the Medium Feed Chute. Feeding this produce through the Large Feed Chute may lead to jamming of the disc.

When dicing tomato, select firmer fruit for optimal results.



TIP

If the food processor stalls when dicing stop the machine and remove the dicing disc very carefully. Using the cleaning cap, clear out the food built up in the dicing grid and dicing disc.



Food Processing Guide - Dicing

FOOD TYPE	TIP	DISH TYPE SUGGESTIONS
Avocado (peeled)	Remove skin	Chunky Guacamole Salad
Beetroot	Can be processed raw or cooked.	Relish Beetroot Risotto Salad
Butternut Pumpkin	Use medium feed chute or pre-cook	Butternut Pumpkin Soup
Carrot	Use small or medium feed chute or pre-cook	Minestrone, Meat Pie Vegetable Soup, Mirepoix
Celery	Trim top and tail	Vegetable Soup, Mirepoix Salad
Onion	Remove skin	Salsa, Soup Sauces Salad
Potatoes	Can be processed raw or cooked.	Potato Salad Mashed Potatoes Soup
Tomatoes		Salsa, Bruschetta Sauces
Apple/Pear	Core and remove pits	Fruit Salad Apple Sauce
Zucchini		Minestrone, Quesadillas, Salsa



Care & Cleaning

Remove the power cord from the power outlet after use for safety reasons.

Blades and Discs are razor sharp, do not touch. Always use the Cleaning Cap, Spatula or Brush to remove food or when cleaning blades. Blades and discs can be washed in the dishwasher.

Once the remaining food is cleared out into the bowl, carefully take the Dicing Grid to the sink and wash it with the Cleaning Brush provided with your Food Processor.

STORAGE

All accessories should be kept in the storage container and out of the reach of children to avoid accidental cuts. It is not recommended to store the discs in a drawer with other utensils.





Notes

Breville Customer Service Centre

Australian Customers

Mail: Locked Bag 2000
Botany NSW 1455
AUSTRALIA

Phone: 1300 139 798

Fax: (02) 9700 1342

Email: askus@breville.com.au

Web: www.breville.com.au

New Zealand Customers

Mail: Private Bag 94411
Botany Manukau 2163
Auckland NEW ZEALAND

Phone: 0800 273 845

Fax: 0800 288 513

Email: askus@breville.co.nz

Web: www.breville.co.nz

Breville
Thought for food

Breville is a registered trademark of Breville Pty. Ltd. A.B.N. 98 000 092 928.
Copyright Breville Pty. Ltd. 2017.

Due to continued product improvement, the products illustrated/photographed
in this brochure may vary slightly from the actual product.