

iQ700 Compact oven with microwave CM833GBB1A

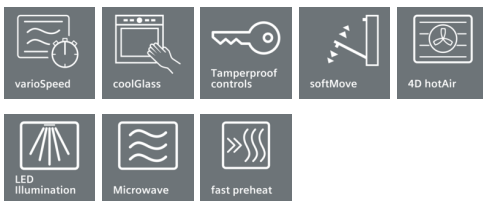

Shorten your cooking time thanks to fast preheat.

- ✓ varioSpeed: up to 50% time-saving thanks to integrated microwave; fast preheat: reach the required baking temperature sooner.
- ✓ varioSpeed: up to 50% time-saving thanks to integrated microwave; fast preheat: reach the required baking temperature sooner.
- ✓ fast preheat: reach the required baking temperature sooner.

Features

Technical Data

Type of micro-wave oven : MW-Combi
Type of control : Electronic
Color / Material Front : Black
Dimensions of the product (mm) : 455 x 594 x 548
Cavity dimensions (mm) : 237.0 x 480 x 392.0
Length electrical supply cord (cm) : 150
Net weight (kg) : 33.8
Gross weight (kg) : 38.0
Maximum micro-wave power (W) : 900
Number of Power Levels : 5
Turntable : No
Heating type : 4D hot air, Combi microwave constant, Full width grill, Half width grill, Hot Air-Eco, Hot air grilling, Microwave, pre-heating
Cavity material : Enamelled steel
Door opening : Handle
Clock : Yes
Included accessories : 1 x combination grid, 1 x universal pan
Main colour of product : Black
Height of the product (mm) : 455
Width of the product (mm) : 594
Depth of the product : 548
Maximum micro-wave power (W) : 900
Connection Rating (W) : 3600
Current (A) : 16
Voltage (V) : 220-240
Frequency (Hz) : 60; 50
Plug type : no plug
Color / Material Front : Black
Approval certificates : CE, VDE
Required cutout/niche size for installation (in) : x x
Appliance Dimensions (h x w x d) (in) : x x
Dimensions of the packed product (in) : 21.25 x 25.59 x 26.77
Net weight (lbs) : 74
Gross weight (lbs) : 83

Included accessories

- 1 x combination grid
- 1 x universal pan

Optional accessories

HZG0AS00 : Connecting cable 3m, HZ915003 : Glass roasting dish, 5,4 L, HZ6LCC0 : Cookbook, HZ6BMA00 : Assembly kit for vertical installation, HZ66X650 : Cover Strip, HZ66X600 : Decor list, HZ636000 : Glass pan, HZ634080 : Baking and roasting grid (microwave), HZ632070 : Multipurpose pan, anthracite enamelled, HZ632010 : Universal pan, non-stick coated, HZ631070 : Baking tray, anthracite enamelled, HZ631010 : Baking tray, non-stick coated, HZ625071 : Grill tray, anthracite enamelled, HZ617000 : Pizza pan, anthracite enamelled, HZ327000 : Baking stone



4 242003 832820

iQ700**Compact oven with microwave****CM833GBB1A****Features****Heating Functions**

- Compact oven with microwave with 6 heating methods:
- 4D HotAir
- 4D HotAir Eco
- Hot air grilling
- Full width grill
- Half width grill
- Plate warming setting
- Additional heating methods with microwave: Pure microwave, Combination microwave and conventional oven
- Temperature range 30 °C - 275 °C
- Cavity volume: 45 net usable litres

Design

- black Steel Design
- Rotary Control
- Anthracite enamel cavity with 3 shelf levels

Cleaning

- Microwave top door

Convenience

- 2,8"-TFT-color and text display with touch-control buttons
- Temperature proposal
- Actual temperature displayActual temperature display
- softMove: gentle opening and closing of the oven door.
- Electronic clock and timer
- Rapid heating-up
- LED lighting
- Integrated cooling fan
- Stainless-steel fan
- Info button
- Bar handle

Accessories

- 1 x combination grid, 1 x universal pan

Safety and Environment

- Door temperature 40 degrees
- Child lock for settings
- Automatic safety switch-off function
- Residual heat indicator
- start button
- Door contact switch

Technical Info

- Length of mains cable: 150 cm
- Nominal voltage: 220 - 240 V
- Total connected load electric: 3.6 KW
- Appliance dimensions (HxWxD): 455 mm x 594 mm x 548 mm
- Installation dimensions (HxWxD): 450 mm - 455 mm x 560 mm - 568 mm x 550 mm
- Please reference the built-in dimensions provided in the installation drawing

iQ700
Compact oven with microwave
CM833GBB1A

Dimensioned drawings

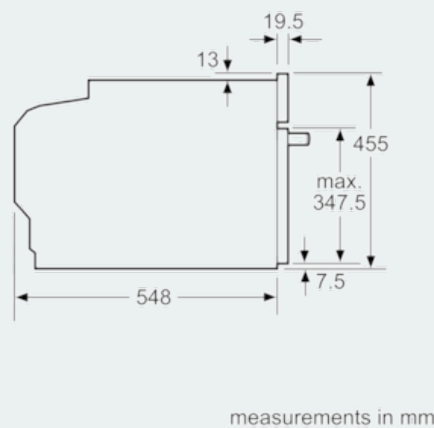
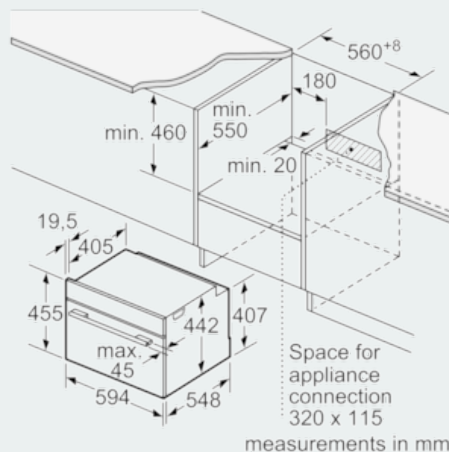

Installation with a hob.

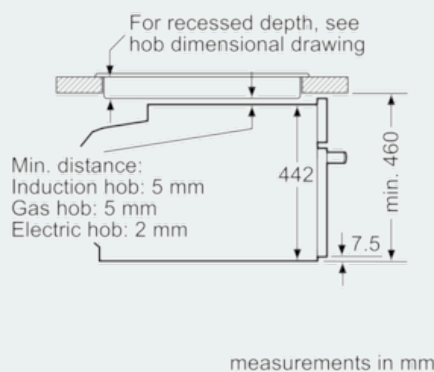

If the compact appliance will be installed underneath a hob, the following worktop thicknesses (including substructure if necessary) must be taken into account.

Hob type	min. worktop thickness	
	fitted	flush
Induction hob	42 mm	43 mm
Full surface Induction hob	52 mm	53 mm
Gas hob	32 mm	43 mm
Electric hob	32 mm	35 mm

